



# Tre - Ysgawen Hall

## Anglesey Suite



**Dimensions** 47 x 38.4ft  
14.3 x 11.7m

**Lighting** Natural  
Wall  
Chandelier

**Electric Outlets** 20 x 13amp

**Telephone** Dial Direct

**Pa System** Yes

**Air Conditioning** Yes

**Power Point**

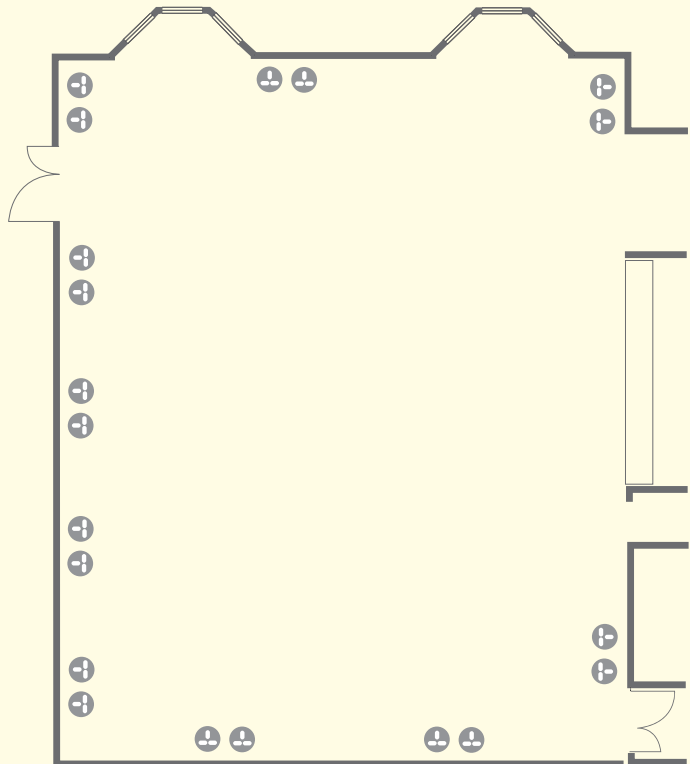

Theatre Style

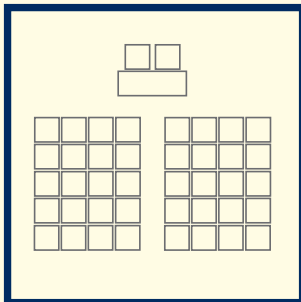

200

Classroom Style

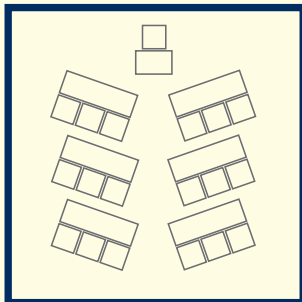

75

Horseshoe Style

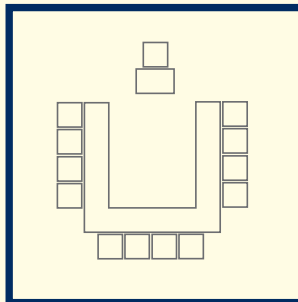

40



# Tre - Ysgawen Hall

## Brittania Room



**Dimensions** 38.5 x 20.6ft  
11.75 x 6.3m

**Lighting** Natural  
Table  
Chandelier

**Electric Outlets** 16 x 13amp

**Telephone** Dial Direct

**Air Conditioning** No

**Power Point**

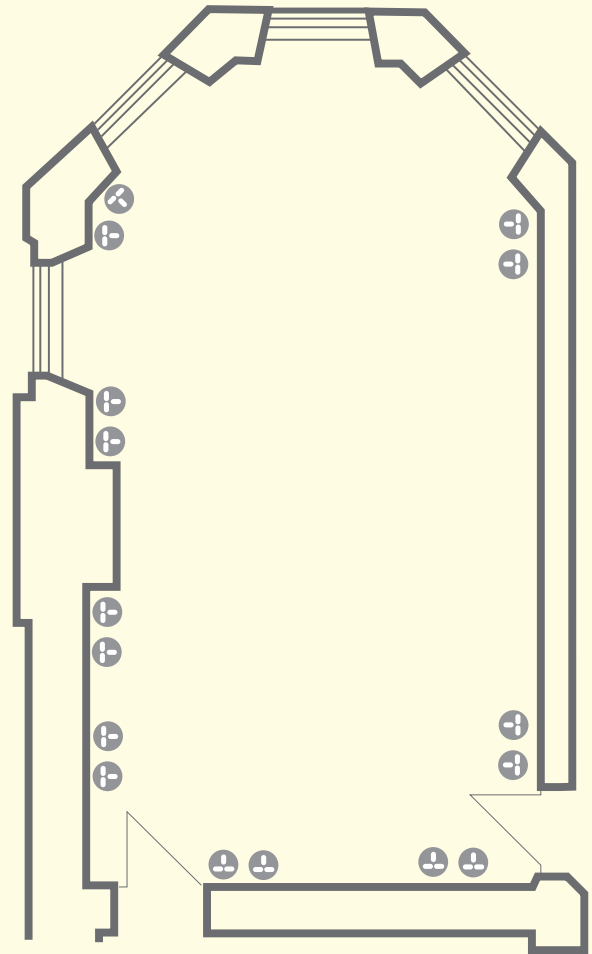

Theatre Style

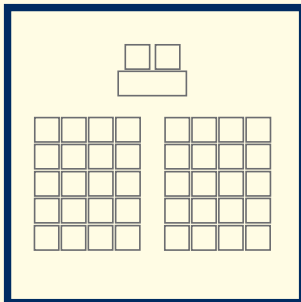

75

Classroom Style

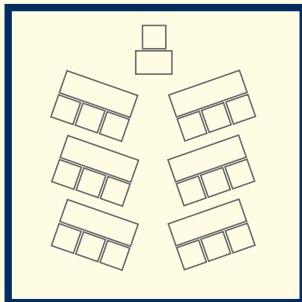

40

Horseshoe Style

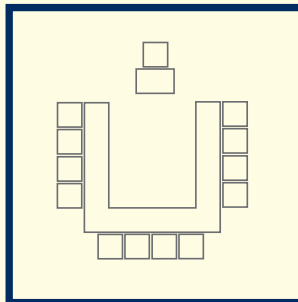

20

Boardroom Style

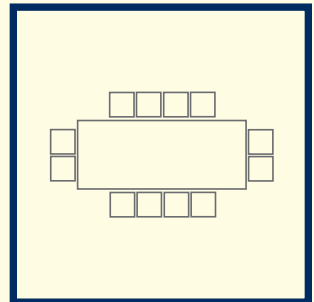

30



# Tre - Ysgawen Hall

## Capel Room



**Dimensions** 22.3 x 19ft  
6.8 x 5.8m

**Lighting** Natural  
Wall  
Chandelier

**Electric Outlets** 12 x 13amp

**Telephone** Dial Direct

**Air Conditioning** No

**Power Point** 

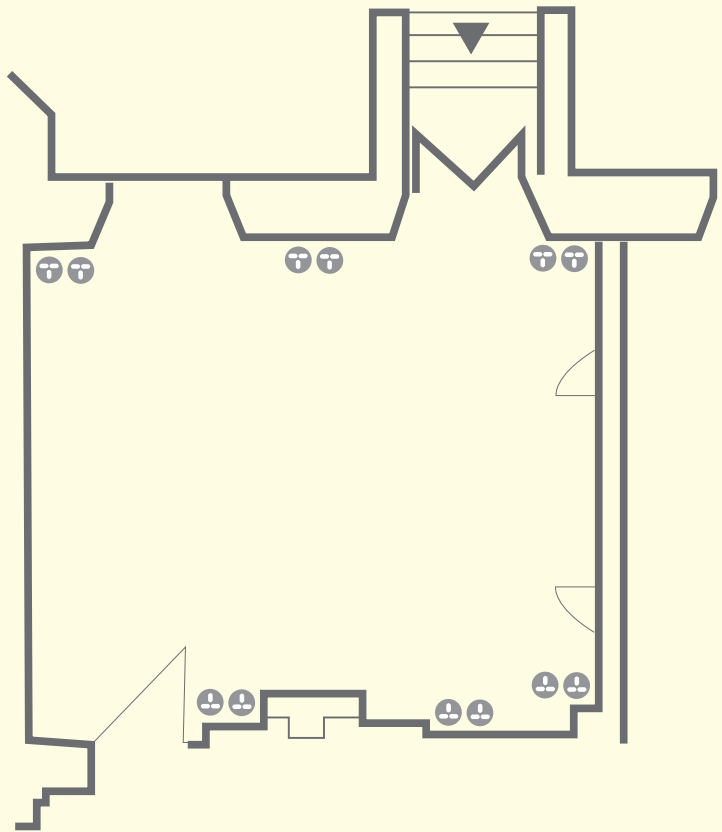

Theatre Style

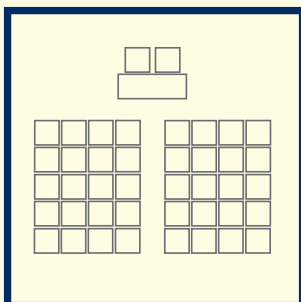

30

Horseshoe Style

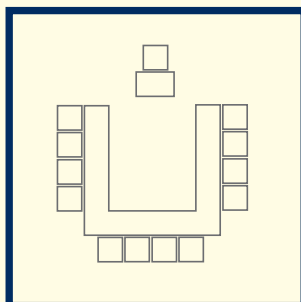

12

Boardroom Style

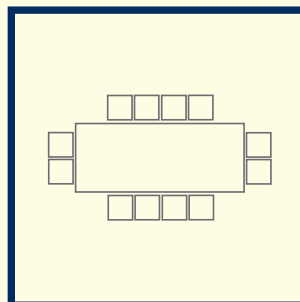

14



# Tre - Ysgawen Hall

## Conservatory



**Dimensions** 38.4 x 34.3ft  
11.7 x 10.45m

**Lighting** Natural  
Chandelier

**Electric Outlets** 8 x 13amp

**Telephone** Dial Direct

**Air Conditioning** No

**Power Point** 

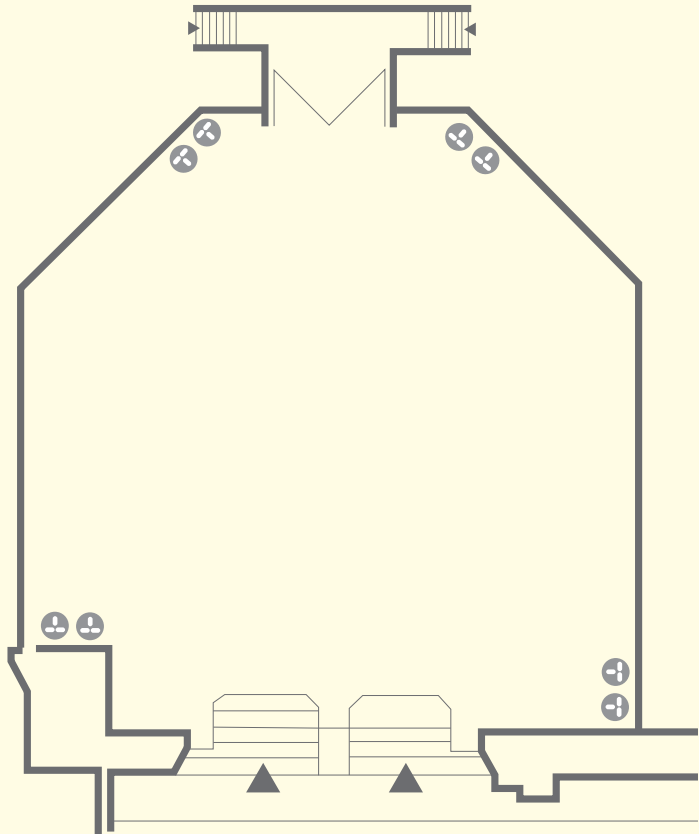

Theatre Style

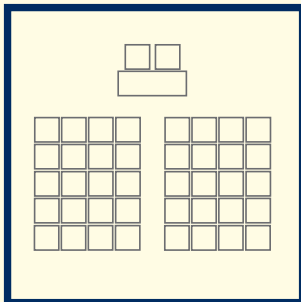

150

Classroom Style

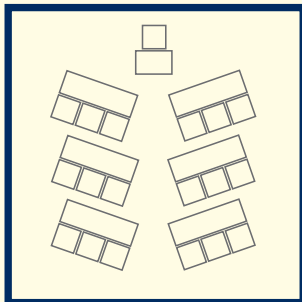

60

Horseshoe Style

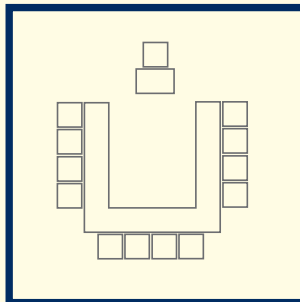

30

Boardroom Style

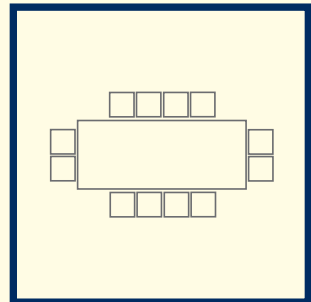

35



# Tre - Ysgawen Hall

## Lecture Suites



<b>Dimensions</b>	37.9 x 23ft 8.5 x 7m
<b>Lighting</b>	Natural Chandelier (dimmers)
<b>Electric Outlets</b>	8 x 13amp
<b>Telephone</b>	Dial Direct
<b>Air Conditioning</b>	Yes
<b>Power Point</b>	

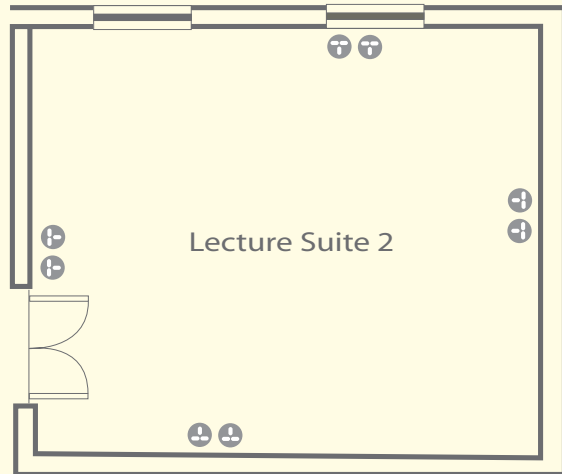
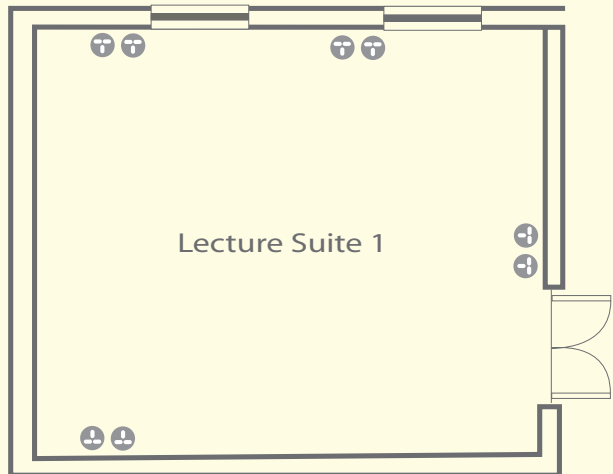

Theatre Style

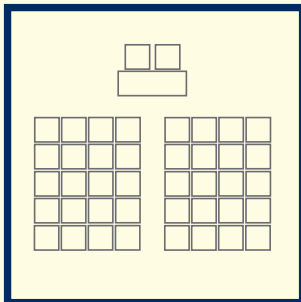

50

Classroom Style

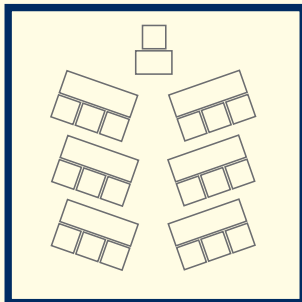

30

Horseshoe Style

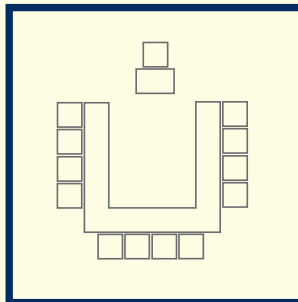

18

Boardroom Style

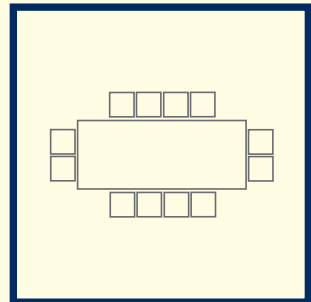

20